

Shape up and get Kent residents fit for 2012

Visit our website

www.tgogc.com

Call us

+44 (0)207 450 4854

Email us

info@tgogc.com

With TGO outdoor gyms, made in the UK



TGO gyms are coming to Kent

The Great Outdoor Gym Company (TGO) is a Great British manufacturer of outdoor gym equipment. TGO gyms contain equipment normally seen in an indoor gym such as cross trainers, bikes, lat pull downs, pull ups and abs benches except they are weatherproof and heavy duty, free to use and designed for the great outdoors. Everyone is able to have free access to TGO gyms 24/7 creating a great space for the whole community to get fit. TGO gyms are also a great meeting space for the community and are a real focal point for positive activity.

The Kent Sport, Leisure and Olympic unit have negotiated special discount packages for Kent councils to take advantage of to help get Kent residents fit for 2012.

Who have we worked with before?

TGO have installed over 250 outdoor gyms across the UK. We have installed gyms in parks, schools and housing estates across the country. The gyms are listed on the TGO website www.tgogc.com.

TGO have also installed over 55 giant gyms for adidas in the shape of the 2012 logo as part of their Olympic legacy project.

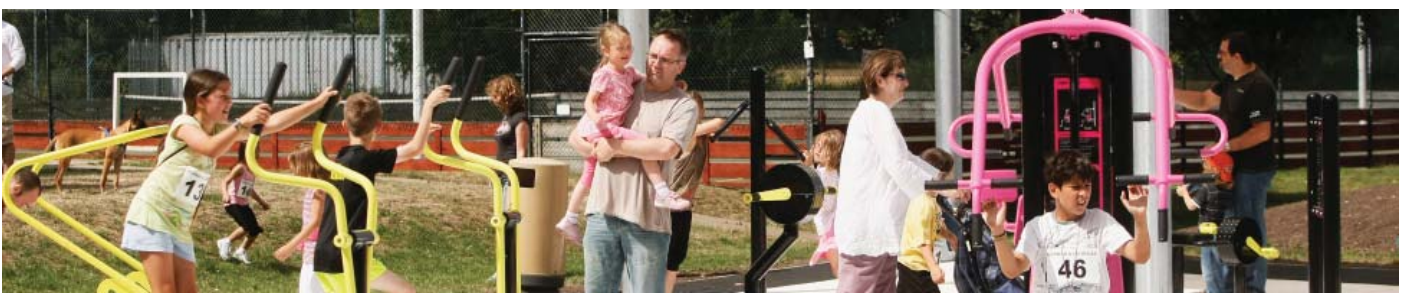



Are they safe?

100% made in Britain

TGO gyms are of the highest standard. TGO are proud to make all the equipment in Britain, unlike some other suppliers who manufacture in China. TGO use the highest quality materials and use skilled welders, fabricators and finishers. Customers can check on production here in the UK and if they have any problems TGO are right here on their doorstep.

made in 
Britain

Compliant to all available relevant standards

TGO are also unique from other suppliers because all their gym equipment is compliant to European playground safety standard EN1176. This means that TGO have eliminated crush points, entrapments, sharp edges and other hazards that have been identified as causing injuries in playgrounds in the past. These standards mean that children and adults can interact with the equipment safely. **We are the only outdoor gym company that meets these standards.**



All TGO installations come with an RPII safety sign off. This means that due diligence has been carried out and the nearest available standard met. TGO are working with the British Standards Institute (BSI) and are sponsoring the new outdoor gym standard PAS 888, meaning that TGO equipment will be at the cutting edge of this new standard too.



Designed for fitness

Designed with an Ex Royal Marines Physical Training instructor. The equipment offers strength, tone and cardiovascular exercises. Every TGO installation ensures the user has a full body workout.

Greg working out on some of our new range of equipment!



TGO Zones

TGO gyms come in variety of shapes and sizes. We have worked with fitness experts to design the most effective layout for the best work out. The packages below are recommendations of the type of TGO gyms that would best serve your community. **All prices are fully installed with a grass mat surface (other surface and inclusive maintenance options available at an extra cost). Phone TGO on 0207 450 4854 and quote TGO/KCC for your discount.**



Bronze equipment:

- Shoulder press
- Lat pull down
- Leg press
- The bench
- Handbike
- Recumbent bike
- 2x Sign frames

Specification:

- 9.5 x 6m
- 6 Station gym
- Safer surfacing
- EN1176 approved
- Designed by our TGO trainer
- 100% made in Britain



1. Bronze

**Kent special
price from
£ 14,782
+ VAT**

2. Silver

**Kent special
price from
£ 18,187
+ VAT**



Specification:

- 7.3 x 8.4m
- 8 Station gym
- Safer surfacing
- EN1176 approved
- Designed by our TGO trainer
- 100% made in Britain

Silver equipment:

- Shoulder press
- Lat pull down
- The bench
- Leg raise
- Dips
- Handbike
- Leg press
- Cross trainer
- 2x Sign frames



Gold equipment:

- Shoulder press
- Lat pull down
- Leg press
- The bench
- Leg raise
- Dips
- Pull ups
- Assisted pull ups
- 2x Recumbent bikes
- Handbike
- Treadmill
- Oblique
- Cross trainer
- 4x Sign frames

Specification:

- 11.7 x 8.1m
- 14 Station gym
- Safer surfacing
- EN1176 approved
- Designed by our TGO trainer
- 100% made in Britain



3. Gold

**Kent special
price from
£ 33,223
+ VAT**

4. Platinum

**Kent special
price from
£48,452
+ VAT**



Specification:

- 14.4 x 11.4m
- 20 Station gym
- Safer surfacing
- EN1176 approved
- Designed by our TGO trainer
- 100% made in Britain

Platinum equipment:

- 2x Cross trainers
- Lat pull downs
- Shoulder presses
- Leg press
- The bench
- Recumbent bike
- Handbike
- Treadmill
- Ski machine
- 2x Oblique trainer
- Pull up/Assisted pull up
- Dips/Leg raise
- 2x triple step ups
- Chest press/Seated row
- 6x Sign frames



1. Full size adiZone

Kent special price from
£151,900k
+ VAT



Specification:

Area - 22.34m x 24.54m
14 station gym equipment
Main info guidepost
5m x 2.45m Tennis wall
Basket ball court
8m x 2m double climbing wall
Football goal end
Freestyle area
Safer surfacing
3 years maintenance included

adiZone equipment:

Leg raise
Dips
Pull up
Assisted pull up
Cross trainer
Leg press
Shoulder press
Lat Pull down
The bench
Handbike
Oblique
Recumbent bike
2x Triple step up
4x Sign frame



Baby equipment:

Leg raise
Dips
Pull up
Assisted pull up
Cross trainer
Leg press
Shoulder press
The bench
2x Fitness bike
Handbike
Oblique
Recumbent bike
4x Sign frame

Specification:

Area: 25m x 12m
Side Fence: 1m height
2012 logo area: 4.5m x 4.5m
11 Station gym equipment
Running track length: 25m
Work out wall: 6m x 2m
(one side mirrored, one side athlete graphics)
Safer surfacing
3 years maintenance included
Fits into a tennis court

2. Baby Stadium adiZone

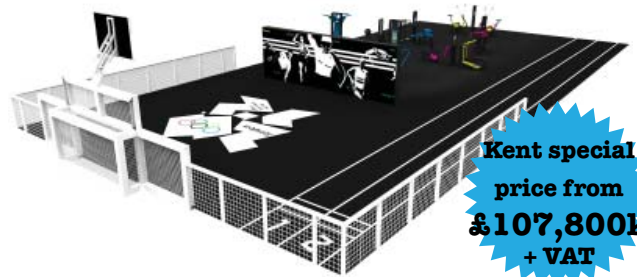

Kent special price from
£107,800k
+ VAT

3. MUGA adiZone

RRP
£75k
+ VAT



Specification:

Overall area - 24m x 18.4m
12m x 20m MUGA with 6 access points (2 DDA accessible)
3,2&1m High Ends
Small sided football goals incorporating basket ball
adidas branded basket ball boards
Unique sound deadening system
Flush mounted panel system (creating true ball re-bound)
Home and away seating zones with adidas branded scoring panels
Thermoplastic line markings throughout (7 year guarantee)
Cricket wickets - integral to fencing
Tarmac surface
Annual maintenance visit



Buzz equipment:

Pull up
Assisted pull up
Cross trainer
Mini cross trainer
Leg press
The bench
Mini recumbent bike
Shoulder press
Lat pull down
Recumbent bike
Handbike
Ski machine
4x Sign frame

Specification:

Area: 25m x 12m
Side Fence: 1m height
2012 logo area: 4.5m x 4.5m
11 Station gym equipment
Running track length: 25m
Work out wall: 6m x 2m
(one side mirrored, one side athlete graphics)
Safer surfacing
3 years maintenance included
Fits into a tennis court

4. Buzz adiZone



Kent special price from
£54k
+ VAT